



bizhub 4750i
bizhub 4050i

A4 Monochrome Multifunctional Printers (MFP)

bizhub **i-SERIES**

RETHINK IT



bizhub 4750i / 4050i



From consulting, system design, to operations, Konica Minolta offers total support to optimise your office output environment.

Requirements for safe use

- Please read and follow the instruction manual to ensure safe operation.
- Only operate using appropriate power supply and voltage.
- Connecting the earth wire to an inappropriate place may cause explosion or electric shock. Please connect accordingly (Taiwan and the Philippines only).

Konica Minolta Business Solutions Middle East DMCC
Jumeirah Lakes Towers, Dubai, UAE
Tel. No. +971 4 880 8388
P.O. Box 338322
Email: marketing-me@konicaminolta.com
URL : www.konicaminolta.com/me



4750i
BW 47 PPM

4050i
BW 40 PPM

Giving Shape to Ideas

TOMORROW'S WORKPLACE TODAY

A NEW WAY OF WORKING HAS ARRIVED



Delivering Simple, Secure and Convenient office work.
We innovate your business, processes and way of working.



i-SERIES SIMPLE

SIMPLIFYING WORK

The User Interface has been completely revamped with an operation panel screen with smart-device-style operability. Operation has been simplified by narrowing down functions and screen transitions to frequently-used functions.



Easy-to-use, new operation panel design

The operation panel features a new simple GUI (Graphical User Interface) design. Features including no hard keys and panel vibration feedback reflect familiar smart devices and enable easy use of a variety of IT services. Simplicity of operation has been achieved by concentrating on frequently-used functions to minimise functions and screen transitions.

GUI operation panel with a choice of two panel styles

The user can switch between two panel styles as required: the new GUI Basic Style characterised by simple operation, and the conventional Classic Style utilising advanced settings and functions. Basic Style also offers an intuitive Simple Copy screen.

Home screen
The screen is divided into an Information Area and a Main Area which are customisable.

- Information Area: displays information such as settings menu buttons, ID button, and user name while logged in.
- Main Area: access to functions such as copying, faxing and scanning.

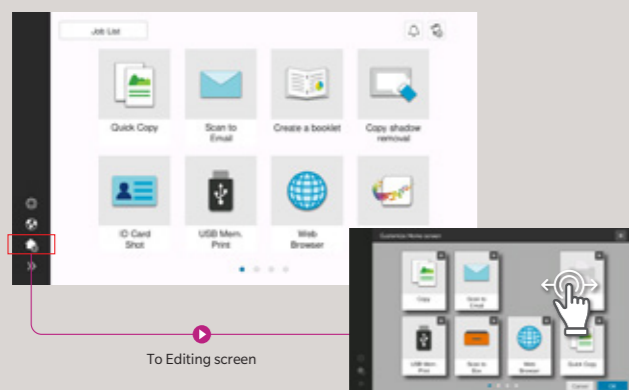

Quick Copy screen
The Quick Copy screen easily executes the intended task with minimal screen transitions.

- Large buttons allow easy browsing and intuitive operation.
- Options are displayed in a list and can be changed with just one touch.

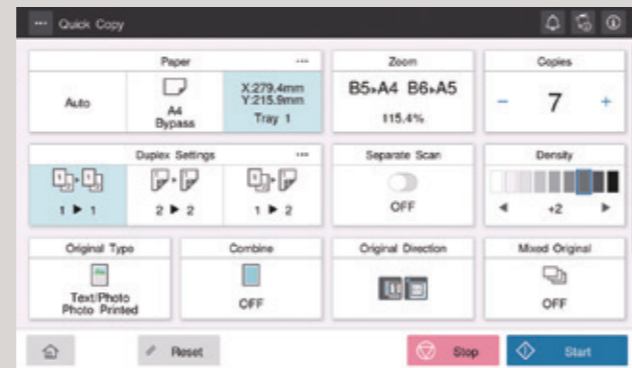

Large, user-friendly touch panels

The bizhub 4750i series feature a newly developed 10.1-inch touch panel to deliver better legibility with smooth, intuitive, tablet-like operation.



Adjustable tilt operation panel

The operation panel can be freely tilted to a maximum of 90 degrees to suit individual users.



Indicator lights

The bizhub 4750i series has been installed with a new LED light that gently harmonises with the environment. The LED, which indicates data receipt or accumulation, is located on the front of the MFP for easy recognition.



Make tasks simple with purpose-specific apps

The bizhub 4750i series simplifies operation with on-screen animated instructions that guide users through tasks. Operations can be performed smoothly in just a few easy steps.

Card shot for ID card copying

Both front and back sides of an ID card can be copied on one sheet of paper in just a few easy steps.



Booklet making

For users who want to create booklets such as magazines.

Non-image area erase function

For users who want to copy with the document cover open, and/or want to omit the shadowy areas around the scanned images of things such as books.

Voice guidance

Voice guidance offers support such as reading out fax numbers, explaining major screens and keys, and key-related operations. It also assists panel operation and prevents mis-operation.

*This function is only for use in enlarged displays on copy, fax and scan screens.
*Requires i-Option LK-104 v3, key pad KP-P03 and device connection I/F kit EK-608 or EK-609.

Colour Universal Design

Konica Minolta has received Colour Universal Design certification from Japan's Colour Universal Design Organization (CUDO).



*In validation tests using subjects with four types of colour-vision deficiencies, (red and green blindness, red and green weakness), CUDO confirmed that regardless of the deficiency, information transmission in colour by this unit functioned correctly.

**i-SERIES
SIMPLE**

THOROUGH PROTECTION OF OFFICE INFORMATION



Data security is an ongoing concern in the corporate world. Konica Minolta works tirelessly to keep clients' documents secure, in both digital and paper formats. By including cutting edge security functions in all Konica Minolta technologies, we aim to reduce the burden on IT administrators.



bizhub SECURE services

Data protection is a major issue for most companies. bizhub delivers advanced security settings through bizhub SECURE services, a total security setting service that provides greater protection for customer data stored in the SSD and device's network settings.

Encrypted SSD

The 4750i series is equipped with a new 256 GB encrypted SSD for heightened security. With very few device compatibility problems, and with full-time encryption, this constantly maintains a high level of security with no fuss.

Secure printing

By setting a password for documents on the printer driver screen, the document is stored on the MFP's SSD until the correct password is keyed in on the operation panel. The document is protected and will not be output until the password set for that document is matched. This is useful when you wish to print confidential documents or give permission for limited users to receive copies.

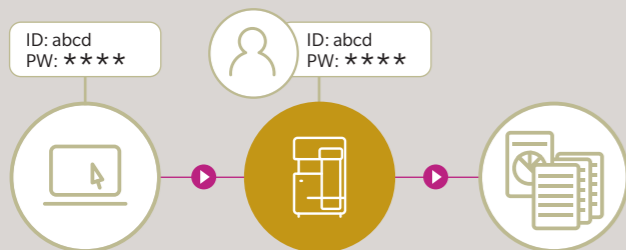

Use PC login user names for easy secure printing

The PC login profile can be used as an ID for secure printing, so the user can print easily and securely once logged in without the trouble of entering his or her ID each time.

Various types of user authentication

Optimal authentication systems can be customised to suit office scale and pre-existing systems. The bizhub 4750i series also supports single sign-on (SSO) which enhances operability without sacrificing security.

Main unit authentication

Authentication can be performed through the bizhub alone. It is also possible to set detailed usage restrictions for functions, including copy, print, scan and fax.

Non-contact IC card authentication

Non-contact IC cards^{*1} such as FeliCa can be used to authenticate users^{*2}. This also supports SSFC (Shared Security Formats Cooperation) specifications which enable integration of staff authentication with authentication systems. Apart from non-contact IC cards, authentication can also be carried out on NFC-compatible Android devices^{*3}.

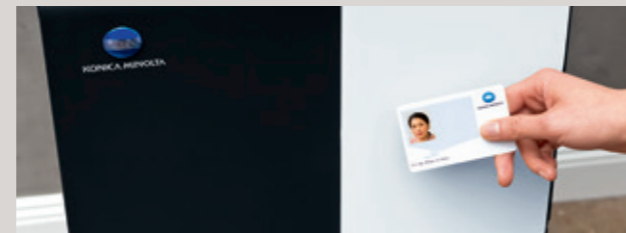

*1 Non-contact IC cards are compatible with FeliCa (IDm), SSFC, FCF, FCF (Campus) and MIFARE (UID).

*2 Requires the IC card authentication device AU-2015 option.

*3 Requires an Android device later than Android 4.4, compatible with HCE (Post Card Emulation), and Konica Minolta Mobile Print.

Biometric authentication

Highly accurate authentication is possible using finger veins. It's easy, and also enables the building of high-level security systems.

*Requires the Biometric Authentication Devices AU-102, EK-P08 or EK-P09 and WT-P03 options.

Supports VLAN (Virtual LAN)

The bizhub 4750i series supports a VLAN function that splits multiple networks logically. Data can be isolated for each network, such as externally vs. internally connected networks, company dedicated vs. guest-only networks, or in shared offices so the bizhub can be used securely.

*For further details please contact your authorised Konica Minolta retailer.

Virus scanning

The 4750i series is equipped with robust antivirus software based on an embedded Bitdefender scan engine to ensure safe connection to devices including PCs, tablets, and USB flash drives. Scanning individual files means much finer virus detection than with the whitelist method alone. Latent viruses in the office are discovered through checking and notification when files are received. Checks are also conducted when files are output from the MFP which prevents dissemination of infected files. Further periodic checking of files in the MFP discovers risky in the network files and detects latent risks in the MFP. Real time virus scan jobs are available for print, scan and fax functions, while manual or scheduled virus scans are possible for folders such as SMB folders on the Box and SSD.

Requires i-Option LK-116.
Requires an internet environment.

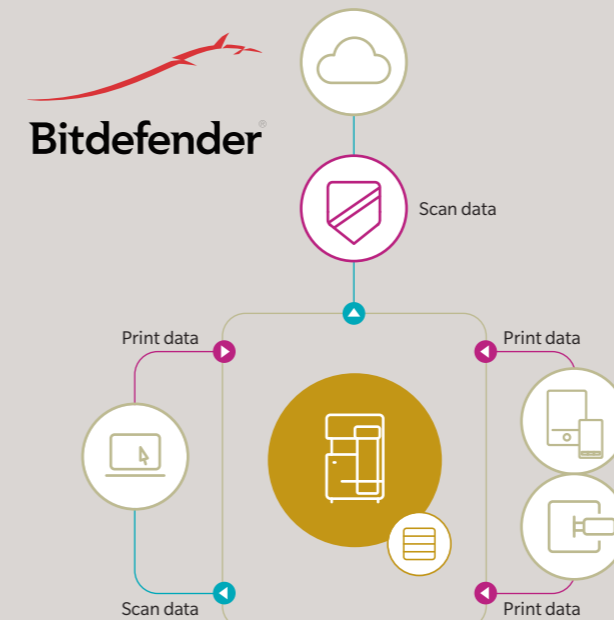

Serverless printing in a ubiquitous network

The bizhub 4750i series achieves serverless printing in a ubiquitous network that outputs previously sent print jobs from any desired MFP in the office network, after authentication. As a base unit for printing, it works as a print server, which enables the easy, low-cost creation of a serverless printing system for ubiquitous computing.

*A print system in a ubiquitous network can be created for up to 100 units.

*Each MFP requires the i-Option LK-114 option.

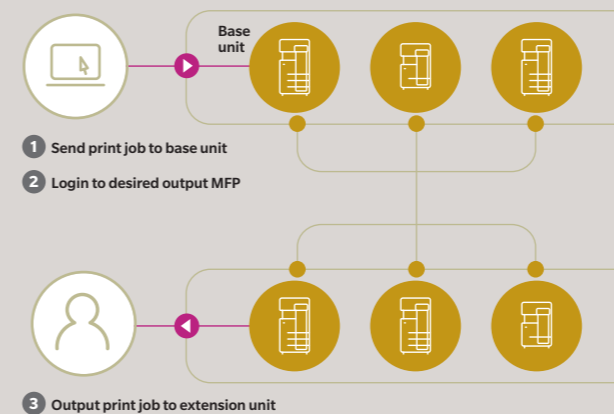

Copy Protect Function

To prevent unauthorized copying, the bizhub 4750i series is equipped with the Copy Protect Function. This function imprints special text, such as "Confidential" and the date inconspicuously in the background of documents.

Encrypted PDFs

• Password encryption

Documents distributed in PDF format can be password encrypted.

• Digital ID encryption

Only authorised recipients with a private key can decrypt. This ensures a far more robust level of security than the previous public key system. If encrypting with Digital ID, the email address (S/MIME send) to which the Digital ID has already been registered must be registered to the MFP's abbreviated address. Requires the i-Option LK-102 v3.

• Electronic signatures

Electronic signatures certify (MFP) document authors, and also guarantee that the document has not been changed and is valid. Certifications by third party organisations can also be used.

When using electronic signatures, files should be encrypted using either a password or Digital ID.

Requires i-Option LK-102 v3.

Recognised high-level security ISO/IEC 15408 certification

To objectively prove the reliability of Konica Minolta MFP security functions, we have obtained the Common Criteria (CC) for Information Technology Security Evaluation (ISO/IEC 15408). The bizhub 4750i series has also obtained CC certification for compliance with HCD-PP v1.0 (Protection Profile for Hardcopy Devices).

Information security-related certification obtained for this product (and this system) demonstrates compliance with certification requirements as a result of evaluations based on specified evaluation standards and methods, but does not assure that the product (or the system) is completely without weaknesses.

Other major security features on the bizhub 4750i series

- SMTP authentication/POP before SMTP authentication enable security to be set when sending emails.
- SSL/TLS protocol enables encryption of data transmission between networks
- Storage Lock Password prevents unauthorised access to the SSD
- TPM (Trusted Platform Module) safely manages confidential information*

* Requires i-option LK-115 v2

FASEC 1-compliant fax security

- Double Address Input prevents erroneous transmission through input error
- Destination Number Confirmation Display prevents erroneous transmission due to incorrect dialling
- Dial Tone Detection function prevents erroneous transmission due to call collision
- Memory Receive & PC Forward prevents paper faxes from being left behind
- Transmission Result Report and Operation Panel Result Check enables verification of fax transmission

Konica Minolta's original fax security

- Send Approval Password function prevents erroneous transmission through thorough checking
- Recipient Confirmation (CSI matching) Send prevents erroneous transmission through mistaken connection
- Voice Guidance when Sending uses voice guidance to prevent erroneous transmission*
- * Requires i-Option LK-104 v3, Key pad KP-P03 and device connection EK-P08 / EK-P09.
- Designated Tray Paper Feed assists security management

**i-SERIES
SIMPLE**

ALWAYS AT THE FOREFRONT



Konica Minolta remotely manages bizhub operating conditions and toner levels, and delivers a variety of support and cloud services including automatic firmware updates and remote monitoring.

Worldwide Remote Service Platform

We developed new services leveraging IoT so users can focus on their core business. i-Series intelligently collects data for self-diagnostic and remote maintenance, as well as predicts the optimum replacement time for parts and consumables to minimise downtime.

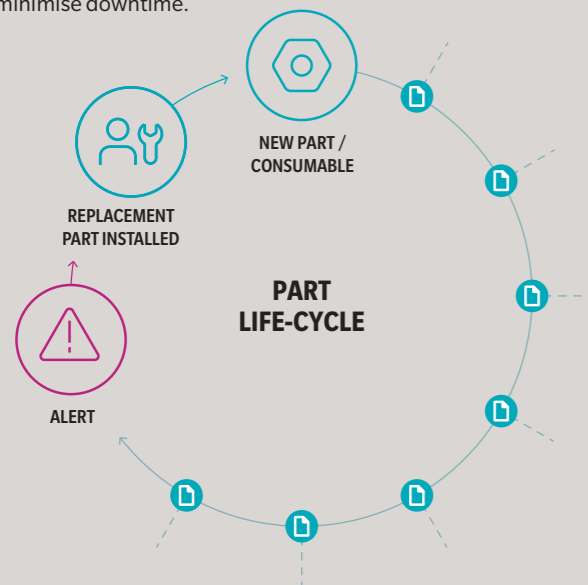

Data collected for part/consumable replacement predictions
For more information, please contact your authorised Konica Minolta retailer.

bizhub Connectors

The operation panel connects to various cloud services^{*1} and corporate internal server SharePoint 2007/2010/2013/2016, enabling connectivity for scan data uploads or direct printing. After logging in to the bizhub, users can also automatically log in under silent mode by entering and saving authentication information to services such as the cloud.

bizhub Connector^{*2} offers 3 applications

bizhub Connector S-1 for Microsoft SharePoint

bizhub Connector G-1 for Google Apps

bizhub Connector E-1 Works with Evernote

*1 Google Drive, Gmail, and Evernote.

*2 Requires a separate set-up fee.

Animated guide

The animated guide demonstrates procedures such as handling paper jams and replenishing consumables. Following the instructions displayed on the operation panel ensures smooth operation.

Web browser function

The bizhub 4750i series supports a web browser function. Websites can be displayed on the operation panel and printed out. Pages in PDF files on the website can be specified and only the required sections printed. This is very handy, allowing easy printing such as of destination maps from the site.

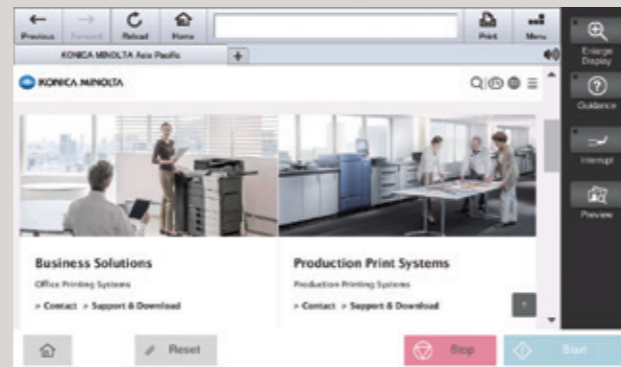

High-performance quad-core CPU

A high performance Cortex A72 CPU Quad Core 1.6 GHz CPU improves overall system performance over the previous model's dual core, 1.2 GHz CPU. The extra CPU cores mean efficient parallel processing of applications, and seamless operation of cloud applications even during basic processing functions such as copying and printing.

HIGH PRODUCTIVITY

High A4 MFP/SFP functionality in a compact design realises convenience and excellent productivity while saving space.

Compact design that fits almost any office environment

The bizhub 4750i series has a compact footprint of 420 mm width and 528 mm depth. Its size lends itself to use in settings such as corporate back offices, deskside in small home offices, or as a departmental machine in large offices.



Same functions as an A3 MFP allows it to ideally harmonise with A3 bizhubs in the office

Despite its space-saving size, the bizhub 4750i series is equipped with a large 10.1-inch touch panel, providing the same operability as an A3 bizhub. In addition to sharing the same body design, it supports the same security, cloud connectivity and maintenance functions. It can harmonise ideally in the office together with an A3 bizhub according to location and the number of users.



Off-line stapler makes time-consuming stapling easy

The optional off-line stapler lets you quickly re-staple an original document that had its staple removed for scanning or copying, or when you need to staple multiple number of documents on the spot right away.



Accelerate business efficiency with 47 ppm high-speed printing and fast start-up

The bizhub 4750i is capable of high-speed monochrome printing up to 47 ppm (A4 portrait) and a fast First Copy Out time of 4.3 seconds or less. Large volumes of documents can be printed quickly to enhance business efficiency and productivity.

	Output speed	Warm-up time	First Copy Out time
	Monochrome Same high-speed printing A3 MFPs	High-speed power-up from turning on the main switch to ready to copy status.	Significantly reduced time from pressing the start button to the output of the first sheet.
4750i	47 ppm	17 sec or less	4.3 sec or less
4050i	40 ppm	13 sec or less	4.8 sec or less

Boost productivity with max. 1,600 sheet high volume paper capacity

Adding two optional 500-sheet paper feed units to the bizhub 4750i series' standard 500-sheet capacity paper feed unit and 100-sheet bypass tray enables a maximum of 1,600 sheets*.

* 80 gsm paper

Customisable according to usage and installation location

Cabinets and castors are available to customise the bizhub 4750i series to suit the office environment and usage settings. Configure as an A4 sub machine in large offices, or as a primary machine in small home offices or retail environments.



COPY / PRINT

Equipped with advanced functions for monochrome MFPs.
Both Copy and Print functions exhibit outstanding performance.

Copy both sides of an ID card onto one sheet with Card Shot function

When copying both sides of an irregular-sized original, such as a license or business card, the front and back sides of the card can be automatically arranged to be printed on the same side of one sheet. Easy copying is possible by selecting the Card Shot app on the User Interface.

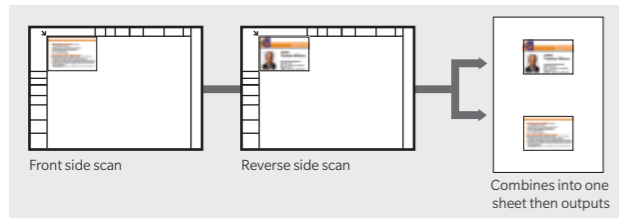

Reduce toner consumption with the Non-Image Area Erase function

When copying with the cover open, such as for thick books, the original is automatically detected and the shadowy area around the original is omitted. This saves excess toner consumption. Easy operation is possible by selecting the relevant apps on the User Interface.

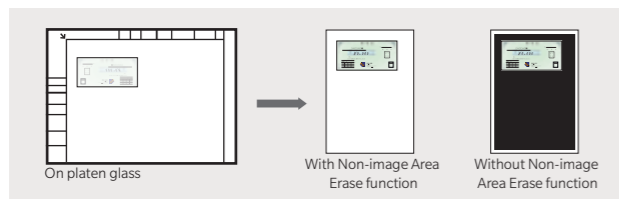

Lightweight paper trays

Paper trays handle easily and open/close smoothly with a light press and pull motion. Trays can be removed for retrieval of jammed paper, which equates to less downtime.



Paper feed and manual feed trays for 60 to 210 gsm paper

Both the main unit paper feed tray and manual feed tray support a wide range of paper from 60 to 210 gsm.

Enhanced 1,200 dpi resolution

The bizhub 4750i series achieves a 1,200-dpi print resolution with superb ability to reproduce small font sizes and fine lines. Such faithful reproduction capability improves document legibility and produces beautiful, high-quality print-outs.

Slows down printing speed.

Feed error sensor

4750i series models are equipped with a sensor in the DSDF to detect any double paper feeds. An error message is displayed allowing the paper to be reset by the user, so now pages go missing during copying via the DSDF.

Carbon Copy Function

Output both actual form documents and marked carbon copies at the same time in a single print job. The carbon copy function supports settings for any number of copies. This eliminates the need to repeat tasks and makes workflow smoother.

Print directly from your USB flash drive

bizhub 4750i series is equipped with a USB port, located on the side of the operation panel. After inserting a USB flash drive, printing procedures pop up in the touch screen, and the flash drive data can be directly printed or saved to a Box in the unit in a few easy steps.

May not operate correctly depending on the type of USB flash drive.
Supported file formats: PDF, compact PDF, JPEG, TIFF, XPS, compact XPS, and OOXML (.docx/.xlsx/.pptx).
Printing results may differ from the image on the PC screen.
Virus check function requires i-Option LK-116.



Other copy functions

- Image Quality Mode to match the original (text, text/photo, photo, faint original, map, copied original)
- Output Mode that matches application (double-sided printing, page aggregation, repeating, grouping, sorting, shifting, booklets, binding margin)
- Diverse Original Document Scan Modes (continuous scan, binding margin, original loading direction, programmed jobs, blank original removal)
- Copy Mode can be set according to objective (book original, consecutive page copying)
- Selectable Layout Adjustment (enlarge/reduce, consecutive enlargement copying, image storage method, mirror imaging, image shift)
- Handy Page Insertion (coversheet, insert sheet, chapter separator, insertion page)
- Expanding usage with Image Additions (date/time, page number, stamp, watermark, head/footer, overlay, registered overlay)
- Able to copy required sections only (Frame Erase, Erase Outside)
- Copy Protect Function that prevents unauthorized copying through inconspicuous background printing

Other print functions

- My Tab Function can customize your own printer driver
- Carbon Copy Mode prints the original docket and copy at the same time

Some functions are only compatible in Classic Mode.



MOBILE

Offers a new workstyle through advanced connectivity with mobile devices.

Mobile communications function

Connectivity with NFC-equipped Android devices

The operation panel has a mobile touch area compatible with NFC-equipped devices. Installing Konica Minolta Mobile Print on Android devices allows that device to be registered to bizhub. Just holding the Android device over the mobile touch area enables the selected file to be printed. Scanned documents in the bizhub can also be scanned and saved to Android devices or cloud storage. Where user authentication is enabled, just holding the Android device nearby allows log in.

Requires the Android device to be equipped with OS4.4 or later.
Requires a wireless LAN environment.

Bluetooth LE connectivity with iOS devices

Using Bluetooth LE (low energy), a bizhub close to the user can be searched and registered with Konica Minolta Mobile Print. As it is also supported with the iOS action button, printing and scan data sharing from various applications can be smoothly executed. Further, where user authentication is enabled, Bluetooth LE can be used to log in.

Requires the device connection I/F kit EK-609 option.
Requires wireless LAN environment.

Create a wireless environment easily with wireless LAN/AP mode

bizhub 4750i series supports Simple Access Point (AP) Mode*, which easily creates a local wireless LAN environment with only the bizhub allowing a wireless LAN to be built separately from the company LAN. Because it bypasses the company LAN, even mobile devices brought in from outside can be securely connected.

* Requires Upgrade Kit UK-221 option^{Base unit}



Supporting a range of print services

Konica Minolta Mobile Print

This is a mobile application offered by Konica Minolta. With a simple and intuitive user interface. Connecting a mobile device with bizhub allows fast, secure scan data acquisition, saving to and sharing cloud storage, as well as document and image printing. Authentication Print and Secure Print are also supported enabling worry-free printing of confidential documents.



AirPrint



Mopria Print Service

SCAN / FAX

The Scan/Fax functions deliver high performance and high functionality from speed, quality and distribution to storage.

Outstanding scan performance

Automatic duplex, simultaneous scanning with an Dual Scan Document Feeder (DSDF), achieves high-speed colour scanning of 90 ipm (45 double-sided A4 sheets per minute). Up to 80 sheets* can be loaded at any one time, significantly reducing scanning time and effort. The precision of automatic skew correction, which adjusts the angle of the scanned original, has been greatly improved to deliver highly accurate scanning with less skew.

80 gsm



Double feed detection sensor

Applying ultrasonic waves to the original distinguishes a layer of air between each page and detects double feeds. When a double feed is detected, a preview of the original that has already been scanned will be displayed so that the job can be restarted without repeating the whole scanning operation from the beginning.

Requires Upgrade Kit UK-P19 option.

Box storage of received data promotes a paperless environment

Received fax data is automatically sorted according to TSI (Transmitting Subscriber Identification) and automatically stored in the bizhub's Box. Setting automatic transfer to client PC or email addresses saves both effort and cost in sorting and distributing received documents. Forwarding to the bizhub's SMB shared folder is also possible. The bizhub 4750i series can also handle functions such as forwarding faxes and TSI-sorted received faxes. The increase in storage destinations for received faxes will further promote a paperless environment.

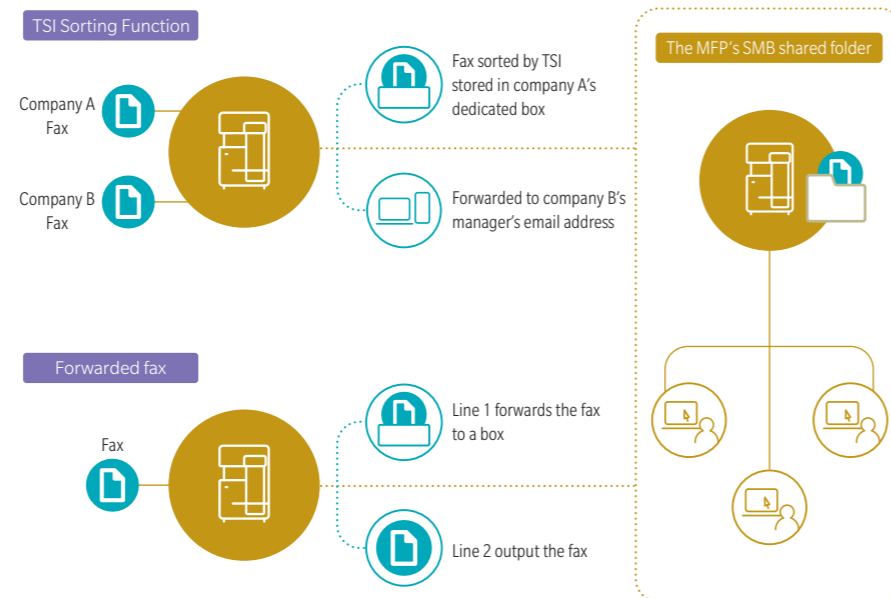

Send large volume scan data with ease using the Scan to URL function

Equipped with a Scan to URL function which stores Scan data within the bizhub, then emails the storage destination URL to the user. This enables easy transmission of large volume data that cannot be attached to emails.

Requires solid state drive EM-908.

Send scan data instantly to your own email address with "Scan (email to me)"

Users can send scan data such as for receipts and payment slips to themselves immediately. This can also be done securely with the authentication setting. As the "Scan (email to me)" button is on the home screen, the data can be scanned and sent quickly in a few easy steps.

Check and print received faxes with Compulsory Memory Receive Box

Received faxes can be checked, managed and printed in a few easy steps by setting the Compulsory Memory Receive Box in the home screen. As the user can select which faxes need to be printed, this function is effective in preventing unnecessary outputs, thus reducing printing costs.

Exclude blank documents from being scanned with blank original removal function

Blank sheets from original documents loaded on the DSDF can be excluded from scanning. Documents detected as blank sheets will not be counted.

Digitisation of paper documents

Documents can be scanned and converted to PDF or OOXML format files. File format can be selected according to the business and intended use, which broadens the scope of secondary use.

Scan to PDF / Scan to OOXML image (with LK-110 v2 installed)

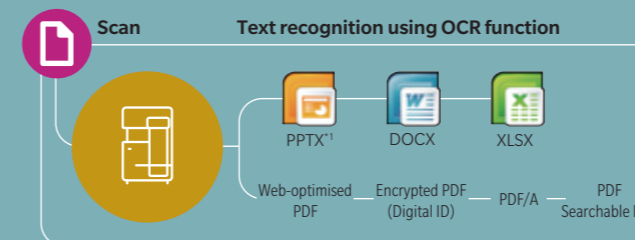

- Applying OCR to a document produces searchable text
- Microsoft Office etc. enables reuse of images and text.

File conversion formats and required options (i-Option)

	LK-102 v3	LK-105 v4	LK-110 v2
PDF/A (long-term archiving)	✓		✓
Web-optimised PDF (linearised PDF)	✓		✓
Encrypted PDF (digital ID)	✓		✓
Searchable PDF (OCR)		✓	✓
OOXML file			✓ ^{*1}
(extension: docx/.xlsx/.ppbx) conversion			
OOXML file		✓ ^{*2}	✓
(extension: docx/.xlsx/.ppbx) conversion +OCR			

*1 pptx conversion is a standard function, but the OCR function requires either LK-105 v4 or LK-110 v2.
*2 Only compatible with pptx.

Improve scan job efficiency

Scanned originals can be converted to a variety of document formats according to the application and stored in the bizhub's box or a USB flash drive. They can also be sent and stored to a PC or server via email, SMB, FTP, or Web DAV.

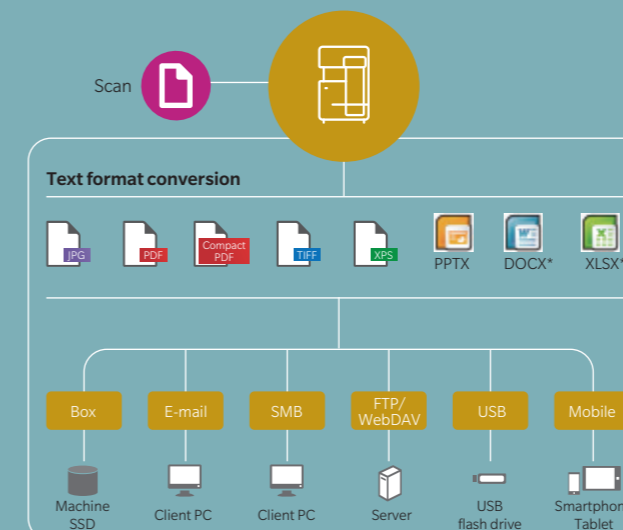

Requires i-Option LK-110 v2

Other main scan and fax functions

- Super G3 Standard achieves high speed sending of approx. 2 seconds
- Direct Fax, paperless sending from a PC
- Convert received data into a Searchable PDF format*
*Requires i-Option LK-110 v2
- W-NET FAX compatibility for broad Internet fax interchangeability
- IP Address Fax (T.38 FAX) reduces transmission costs*
*Requires i-Option LK-117 and Fax kit FK-517
- Address Storage for a maximum of 2000 addresses (100 groups)
- Banner Scan scans long originals from the ADF

Task Automation Tools

Sold separately

Dispatcher Phoenix

Dispatcher Phoenix automates digitised document processes from file aggregation to processing and distribution. By dividing processes via pre-set conditions, such as OCR processing, file renaming and barcode scanning, each document is automatically stored at a destination. This delivers one-touch execution of cumbersome tasks. Start times can be scheduled so that digitised tasks can be executed quickly and efficiently. Broad scalability and versatility, including connectivity with cloud services, enable creation of flexible workflows tailored to the customer's business and office environment.

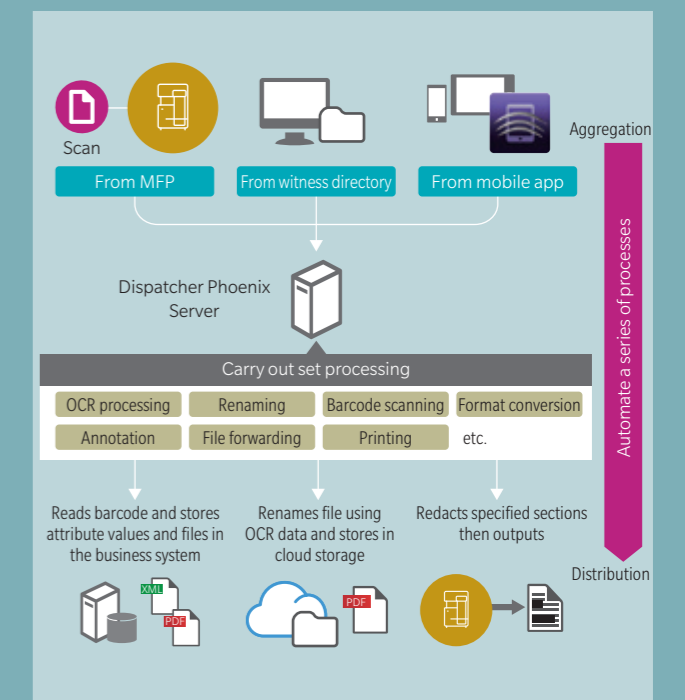

Some functions are only compatible in Classic Mode.